

Torque

Use Instructions

Bluetooth OBDII for Android

1. Install OBDII



2. Install Android Software **Torque**

a) Copy software to phone from CD

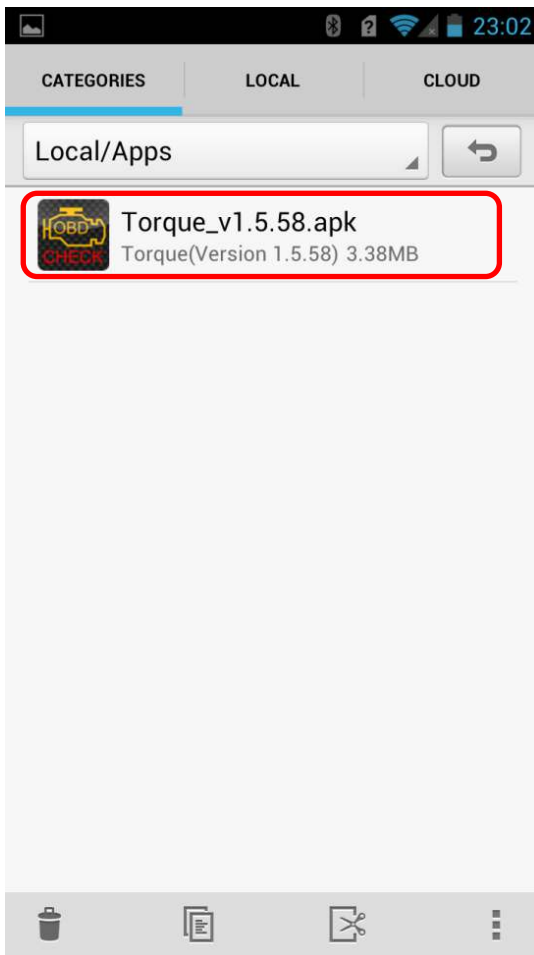

b) Install Software

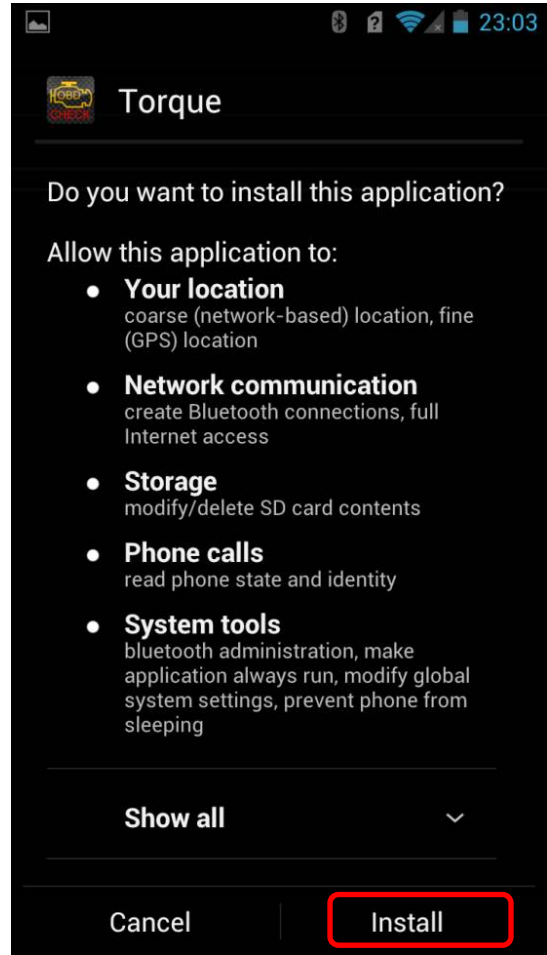

3. Connection OBDII

a) Search OBDII Bluetooth

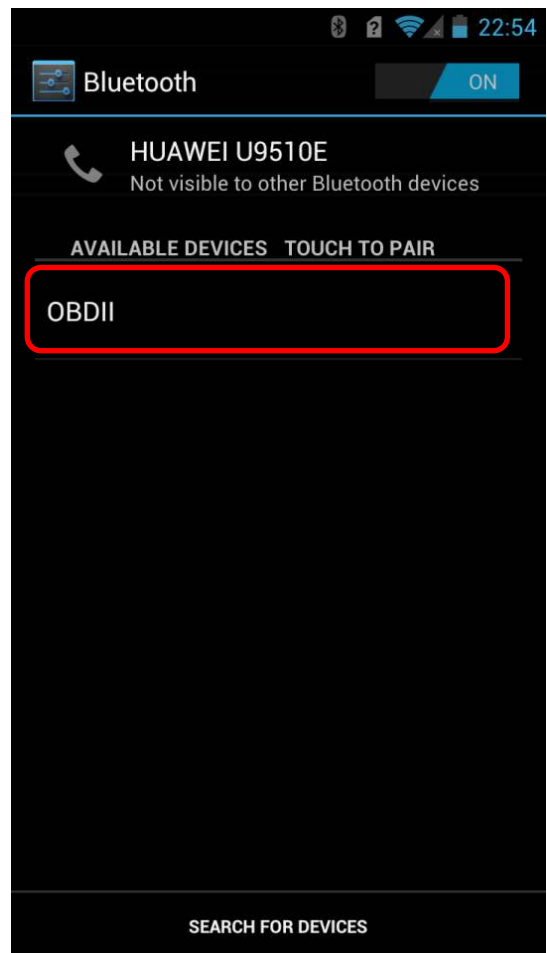

b) Enter the password "1234"

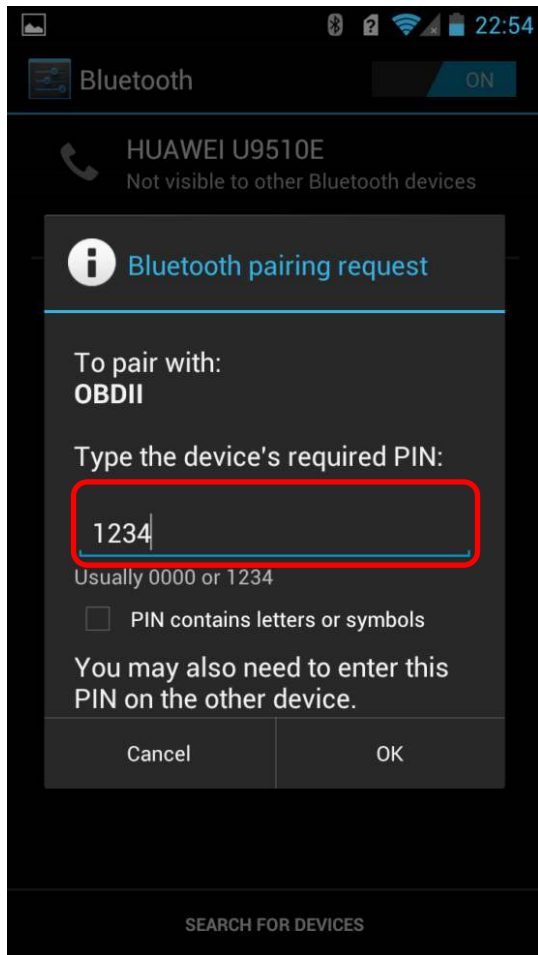

c) Connection Success

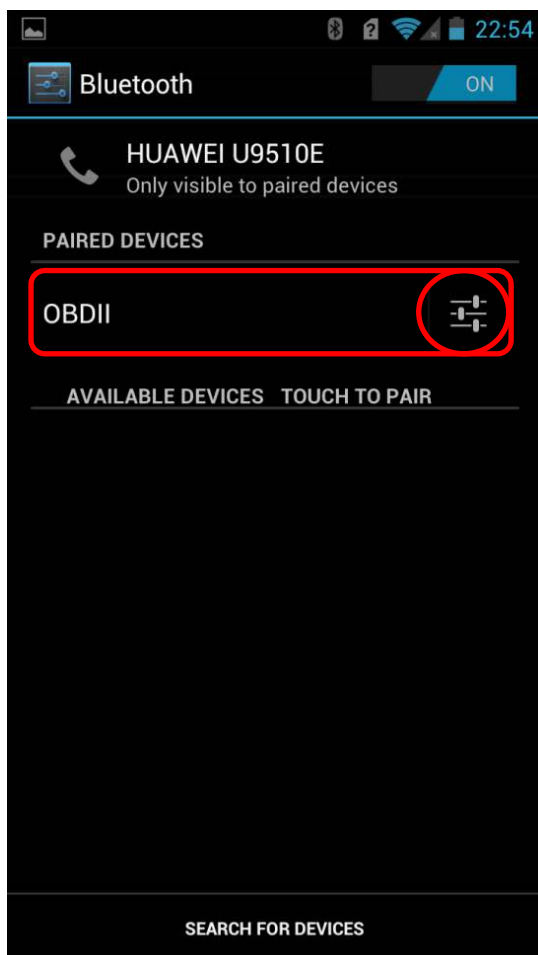

4. Run Software

Click **Menu** button setting Bluetooth connection

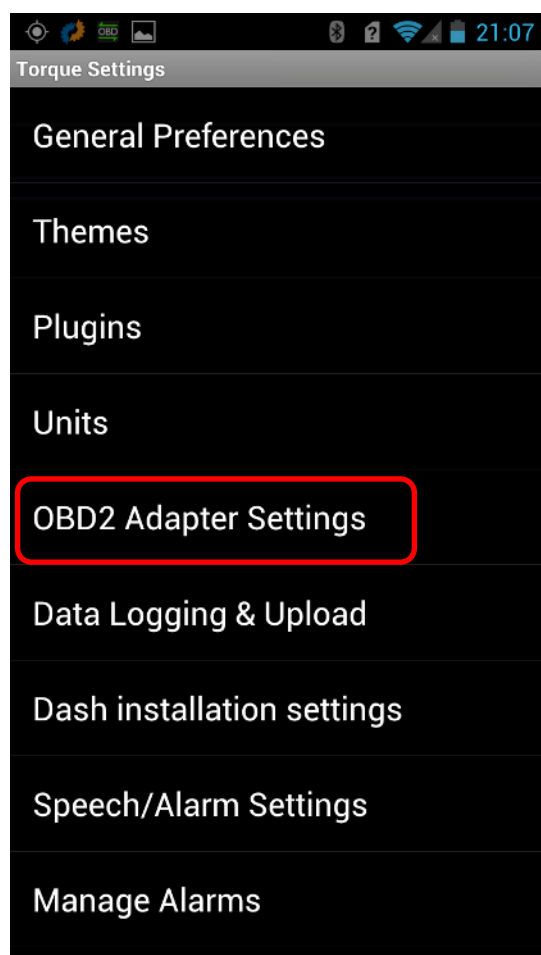

a) Choose Connection type is **Bluetooth**

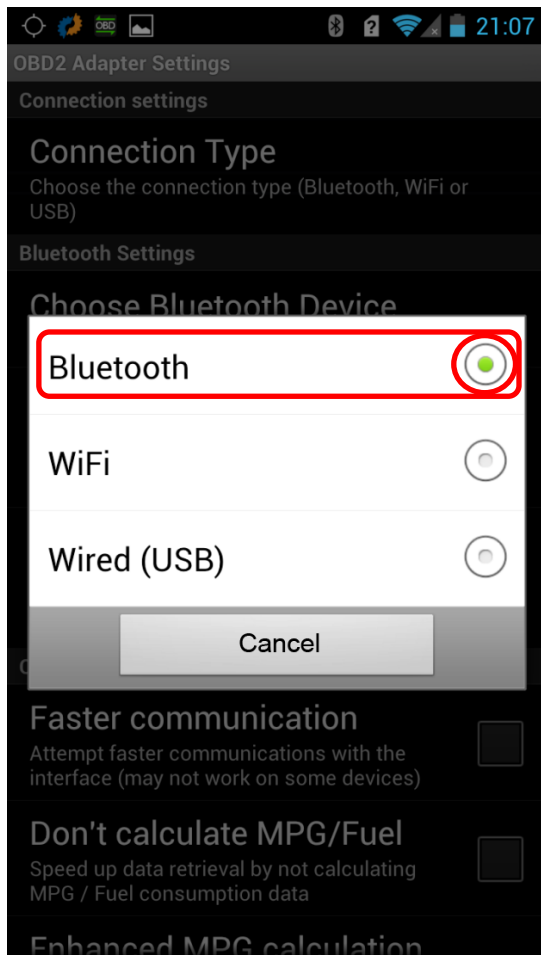
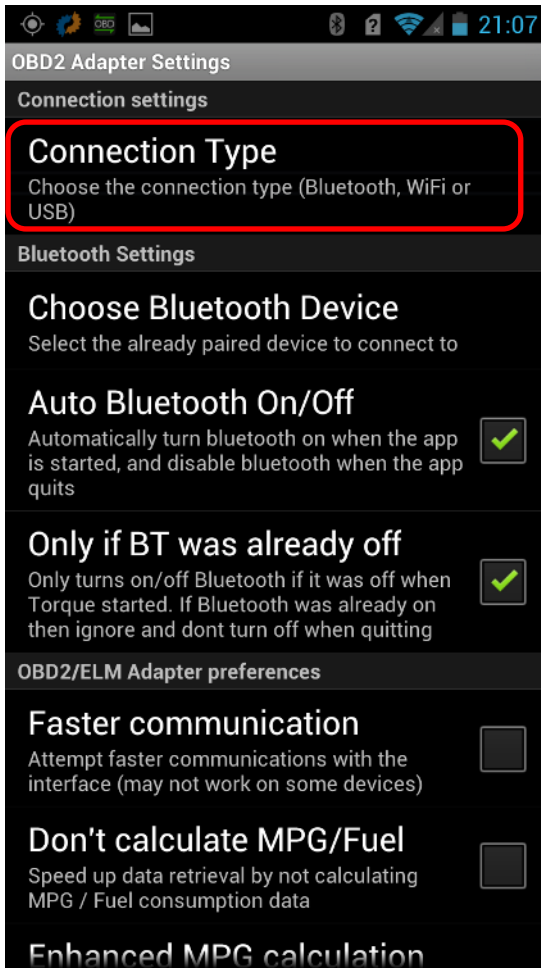

b) Choose Bluetooth Device is **OBdII**

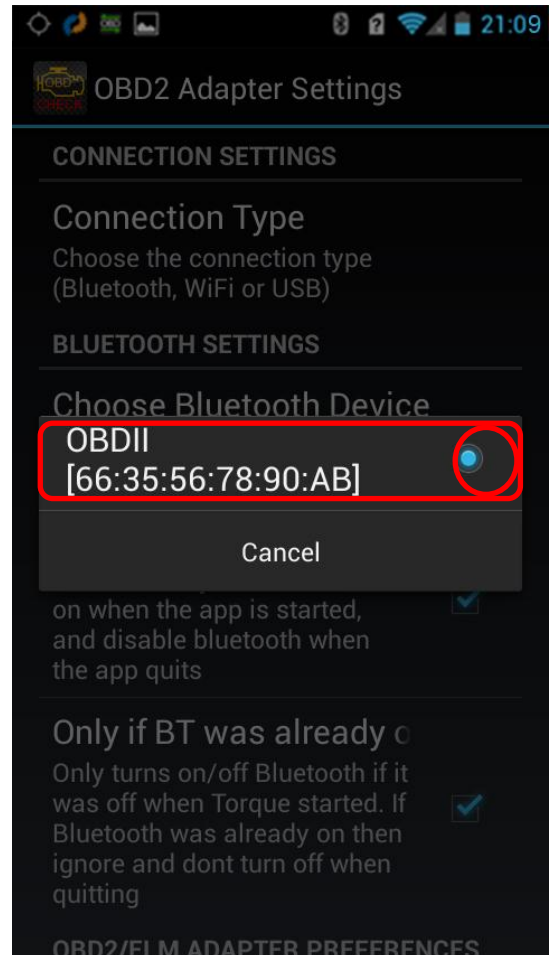
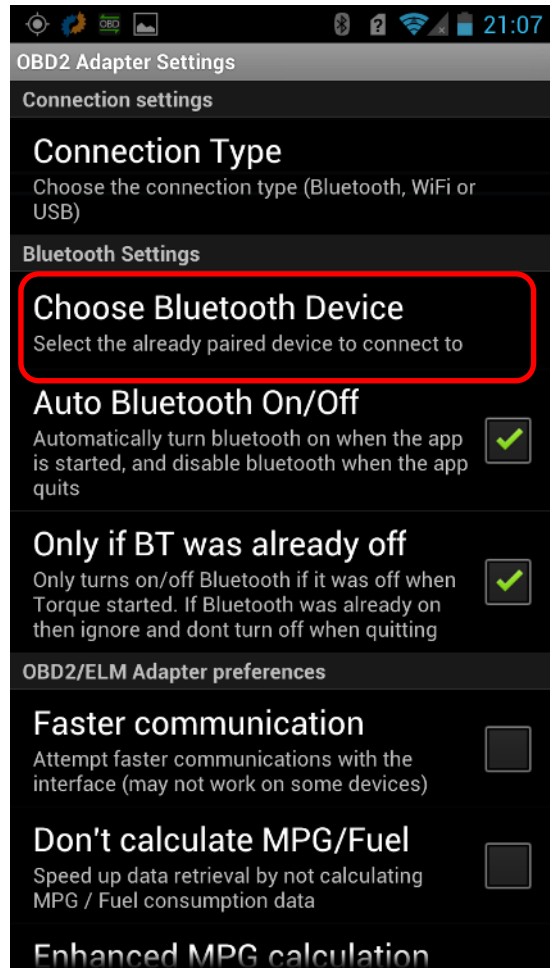

5. Successful connection

